

SI-7871

- LA-7871 Preprocessor for MPC500/800 Family (center)
- LA-7877 Preprocessor for MPC500/800 Family (edge)

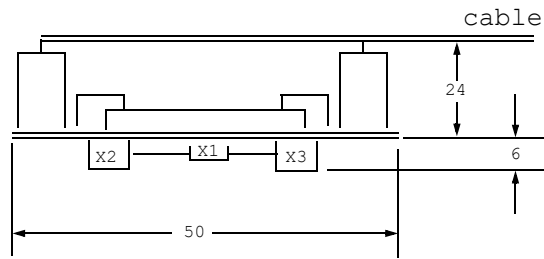

SIDE VIEW

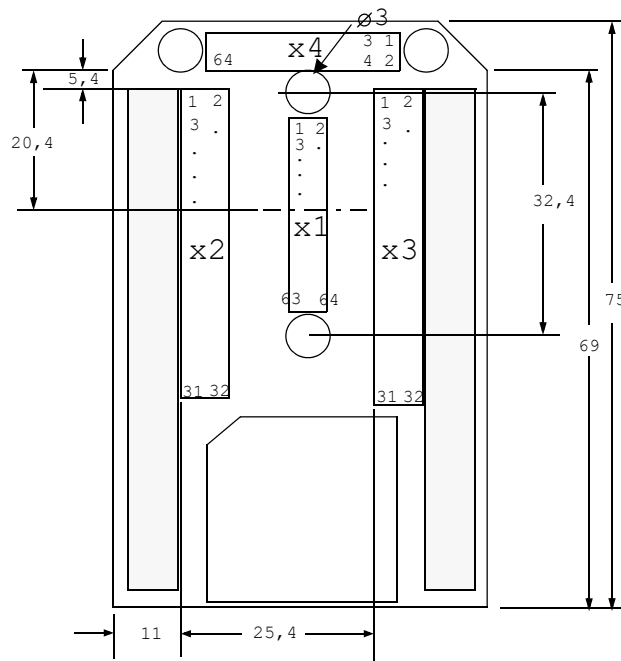

TOP VIEW (all dimensions in mm)

SI-7871

Technical Information

Connector Description

You can use either the X1/X4 connector or X2 and X3 connectors. X1 is soldered on the LA-7871 probe (center connection). X4 is soldered on the LA-7877 probe (edge connection). The soldering holes for x2 and x3 connectors are prepared, but the connectors are not soldered in.

Connector	On LA-7871/7877	On Target
X1/X4	Samtec: CLE-132-01-G-DV	Samtec: FTE-132-02-G-DV
X2	2x16 socket strips, 2,54mm	2x16 terminal strips, 2,54mm
X3	2x16 socket strips, 2,54mm	2x16 terminal strips, 2,54mm

Signal Name MPC555	Signal Name MPC505/509	Signal Name MPC850	Signal Name MPC860	X1/ X4	X2	X3
A20	A20	A20	A20	1	1	
A21	A21	A21	A21	2		1
A11	A11	A11	A11	3	2	
A22	A22	A22	A22	4		2
A19	A19	A19	A19	5	3	
A23	A23	A23	A23	6		3
A18	A18	A18	A18	7	4	
A24	A24	A24	A24	8		4
A17	A17	A17	A17	9	5	
A12	A12	A12	A12	10		5
D11	D11	D11	D11	11	6	

“

Technical Information

A13	A13	A13	A13	12		6
RW	RW	RW	RW	13	7	
A14	A14	A14	A14	14		7
D08	D08	D08	D08	15	8	
A15	A15	A15	A15	16		8
VCC3.3	VCC3.3	VCC3.3	VCC3.3	17	9	
A16	A16	A16	A16	18		9
D03	A03	CS3	A03	19	10	
WE2	BE2	WE2	WE2	20		10
D02	A02	CS2	A02	21	11	
LWP0	WP0	IPB4/LWP0/ VF0	IPB4/LWP0/ VF0	22		11
D01	A01	CS1	A01	23	12	
WE3	BE3	WE3	WE3	24		12
D00	A00	CS0	A00	25	13	
BR	CT1	IPB3/IWP2/ VF2	IPB3/IWP2/ VF2	26		13
VCC5	VCC5	VCC5	VCC5	27	14	
D10	D10	D10	D10	28		14
WE0	BE0	WE0	WE0	29	15	
D09	D09	D09	D09	30		15
GND	GND	GND	GND	31	16	
IWP0/ VFLS0	VFLS0	IPB0/IWP0/ VFLS0	IPB0/IWP0/ VFLS0	32		16
CLKOUT	CLKOUT	CLKOUT	CLKOUT	33	17	
IWP1/ VFLS1	VFLS1	IPB1/IWP1/ VFLS1	IPB1/IWP1/ VFLS1	34		17
WE1	BE1	WE1	WE1	35	18	
BG	CT0	IPB5/LWP1/ VF1	IPB5/LWP1/ VF1	36		18
D07	A07	A07	A07	37	19	
BB	CT2	N/C	N/C	38		19
D06	A06	A06	A06	39	20	
A10	A10	A10	A10	40		20
D05	A05	CS5	A05	41	21	

“

Technical Information

A09	A09	A09	A09	42		21
GND	GND	GND	GND	43	22	
A08	A08	A08	A08	44		22
D04	A04	CS4	A04	45	23	
STS	CSBOOT	OP2/MODCK1/ STS	OP2/MODCK1/ STS	46		23
A26	A26	A26	A26	47	24	
TS	TS	TS	TS	48		24
A29	A29	A29	A29	49	25	
PTR	N/C	IPB7/PTR/AT3	IPB7/PTR/AT3	50		25
A30	A30	A30	A30	51	26	
VFLS0 /PIO32B3	CT3	CS6	N/C	52		26
A27	A27	A27	A27	53	27	
VFLS1 /PIO32B4	AT0	CS7	N/C	54		27
A31	A31	A31	A31	55	28	
VF1	VF1	ALEB/DSCK/ AT1	ALEB/DSCK/ AT1	56		28
A28	A28	A28	A28	57	29	
VF0	VF0	IPB6/DSDI/ AT0	IPB6/DSDI/ AT0	58		29
A25	A25	A25	A25	59	30	
VF2	VF2	IPB2/IOIS16_B/ AT2	IPB2/IOIS16_B/ AT2	60		30
TSIZ0	TSIZ0	TSIZ0	TSIZ0	61	31	
TSIZ1	TSIZ1	TSIZ1	TSIZ1	62		31
TA	TA	TA	TA	63	32	
AT2	AT1	N/C	N/C	64		32